



DATA SHEET

DAB PUMPS S. p. A.
Via Marco Polo, 14 - 35035 Mestrino (PD) - Italy
Ph. +39 049 9048811 - Fax +39 049 9048847
Http://www.dabpumps.com

12/05/2010

Receiver

From

Societa
Reference
Address
Telephone
Fax
E-mail

Item no. 1030224

Pump data :

Model :
NOVA 6
Pressure rating :
Min. fluid temperature : 273 K
Max. fluid temperature : 308 K
Max. Temperature operating : 313 K

Requested data :

Flow : 0 l/s
Head : 0 m
Fluid : Water, p
Fluid Temperature : 293 K
Density : 998.3 kg/m³
Kinematic viscosity 1.005 mm²/s
Vapor pressure : 100 kPa

Available data :

Flow :
Head :

Materials :

Pump body Technopolymer
Impeller Technopolymer
OR ring Rubber NBR
Motor top body AISI 304 X5 Cr Ni 1810 UNI 6900/71
Rotor shaft AISI 416 X12 CrS 13 UNI 6900/71
Seeger ring 12E - UNI 7435 STAINLESS
Wearing disc (Only for NOVA) Technopolymer

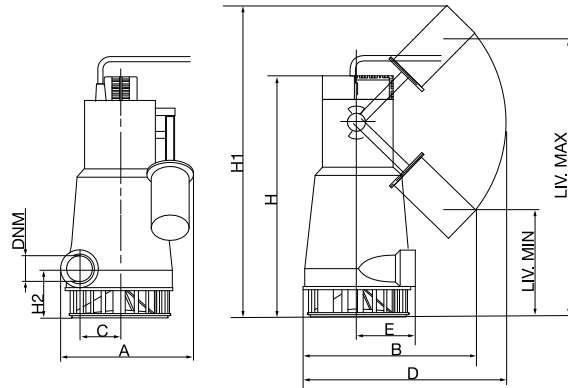
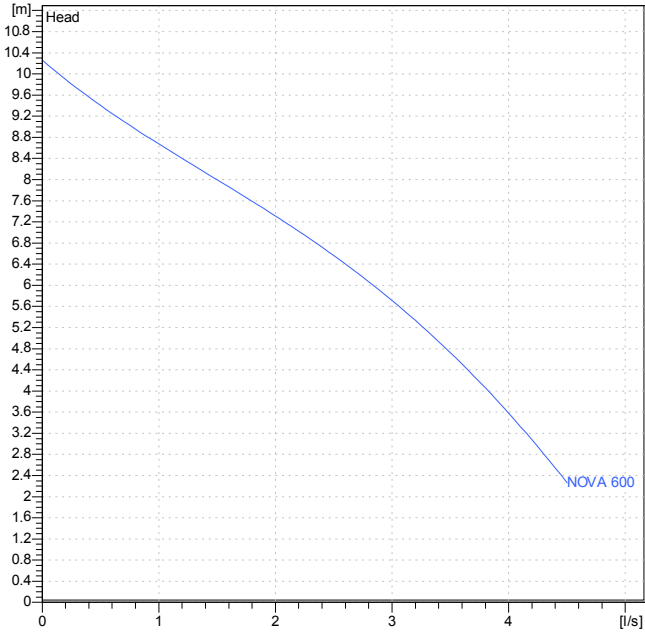

Motor data :

Weight : 7 kg

Trade mark : DAB
Nominal power P2 : 0.55 kW
Rated speed: 2850 1/min
Rated voltage : 1~ 230 V 50 Hz
Nominal current : 3.4 A
Degree of protection : IP 68

Dimension mm

Dimension	Value	Dimension	Value
A	193	H1	443
B	235	H2	73
C	56	LIV MAX	390
D	296	LIV MIN	190
DNM	1"1/4 G		
E	90		
H	368		

Pump connection :

Suction side : /
Discharge side : 1 " 1/4 G' --



PERFORMANCE CURVES

12/05/2010

DAB PUMPS S. p. A.
Via Marco Polo, 14 - 35035 Mestrino (PD) - Italy
Ph. +39 049 9048811 - Fax +39 049 9048847
Http://www.dabpumps.com

Receiver

From

Societa
Reference
Address
Telephone
Fax
E-mail

NOVA 600 M-A

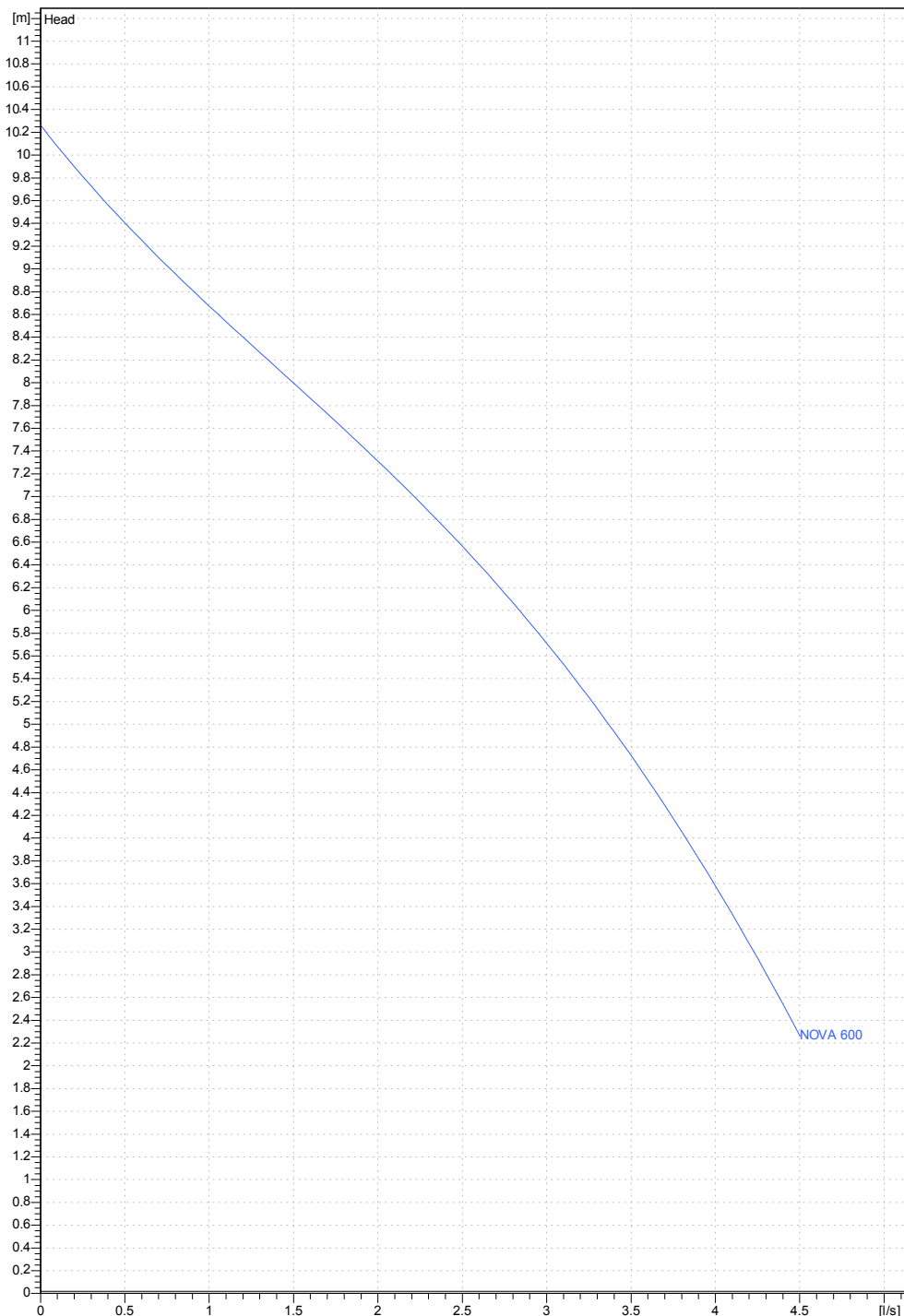

Available data :

Suction side : /	Discharge side : 1 " 1/4" G-	Flow : 0 l/s	Head : 0 m	Speed 2850 1/min
Project	Project ID	Created by	Created on 12.05.2010	



DIMENSIONAL DRAWING

12/05/2010

DAB PUMPS S. p. A.
Via Marco Polo, 14 - 35035 Mestrino (PD) - Italy
Ph. +39 049 9048811 - Fax +39 049 9048847
Http://www.dabpumps.com

Receiver

From

Societa
Reference
Address
Telephone
Fax
E-mail

NOVA 600 M-A

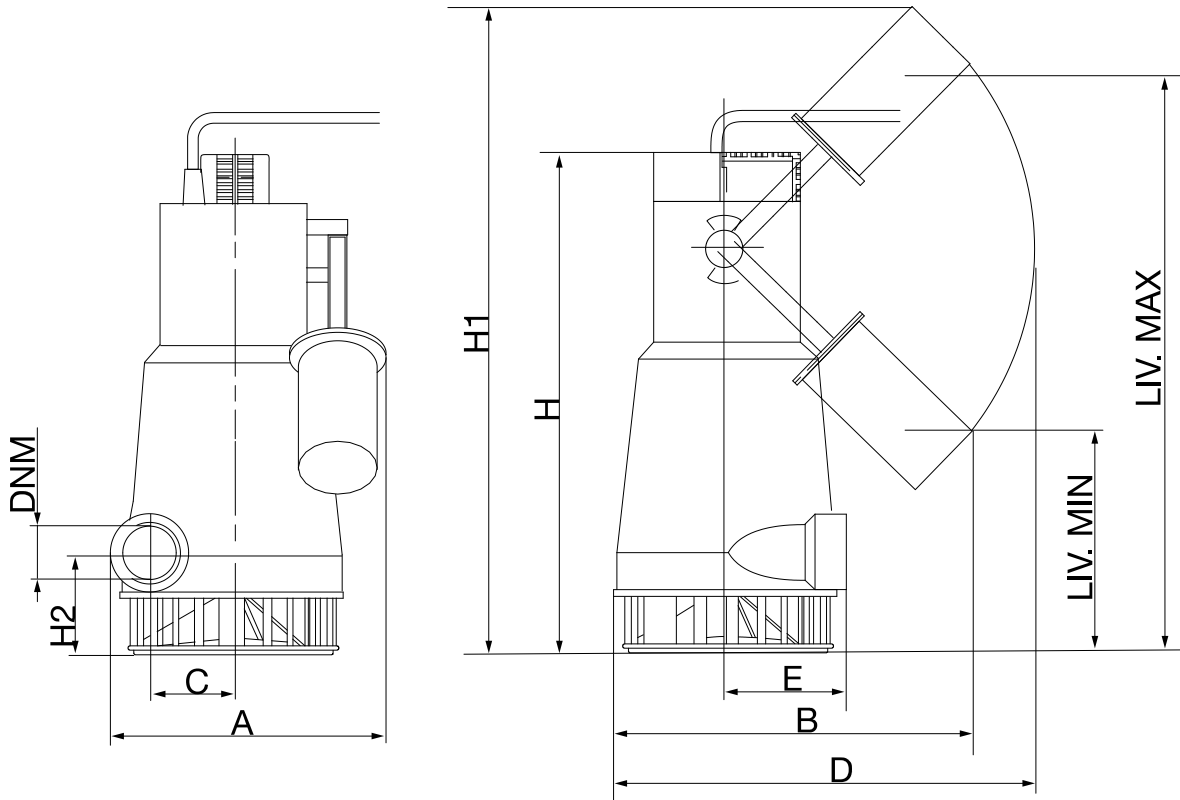

Dimensions in mm

Pump connection :

1	A	193	LIV MIN	190								
2	B	235										
3	C	56										
4	D	296										
5	DNM	1"1/4 G										
6	E	90										
7	H	368										
8	H1	443										
9	H2	73										
10	LIV MAX	390										

Suction
i

Discharge
1 " 1/4

--

Project

Project ID

Created by

Created on

12.05.2010